

Quick Start Guide

LEGEND SERIES

Thank you for your purchase.

The Operating Manual for English can be found at <https://legend.refrigerantid.com>

Read & Understand the Operating Manual before use.

Use proper personal protective equipment.

Français

Nous vous remercions de votre achat.

Le manuel d'utilisation en français est consultable à l'adresse suivante:

<https://legend.refrigerantid.com>

Nous vous invitons à le lire et le comprendre avant toute utilisation.

Utilisez un équipement de protection personnelle adapté.

Português

Obrigado pela sua compra.

O Manual de Instruções em português pode ser encontrado em:

<https://legend.refrigerantid.com>

Leia e entenda o Manual de Instruções antes do uso.

Use equipamentos de proteção individual adequados.

日本語

このたびはお買い上げいただきましてありがとうございます。
ごとうざいます。

日本版の取扱説明書は

<https://legend.refrigerantid.com>

からご利用いただけます。

ご使用前に取扱説明書をよく読み、十分ご理解ください。

適切な個人用保護具を着用してください。

Deutsch

Vielen Dank für Ihren Kauf.

Die Bedienungsanleitung in Deutsch finden Sie unter:

<https://legend.refrigerantid.com>

Bitte lesen und verstehen Sie die Bedienungsanleitung vor der Verwendung.

Verwenden Sie ordnungsgemäße persönliche Schutzausrüstung.

Español

Gracias por su compra.

Puede encontrar el Manual de funcionamiento en español en:

<https://legend.refrigerantid.com>

Lea y comprenda el Manual de funcionamiento antes de utilizarlo.

Use equipos de protección personal adecuados.

한국어

구매해 주셔서 감사합니다.

한국어 사용 매뉴얼은

<https://legend.refrigerantid.com>

에서 보실 수 있습니다.

사용하기 전에 사용 매뉴얼을 읽고 이해하십시오.

적절한 개인 보호 장비를 사용하십시오.

Italiano

Grazie per avere acquistato questo prodotto.

Il Manuale per l'uso in italiano è disponibile sul sito :

<https://legend.refrigerantid.com>

Leggere attentamente il Manuale per l'uso prima di iniziare.

Usare appropriati dispositivi di protezione personale.

中文

感谢您购买本产品。

<https://legend.refrigerantid.com>

提供本操作手册的中文版本。

使用前请阅读并完全理解本操作手册。

使用适当的个人防护设备。

русский

Благодарим вас за покупку.

Руководство по эксплуатации на русском языке можно найти на веб-сайте

<https://legend.refrigerantid.com>

Перед использованием оборудования следует ознакомиться с содержанием руководства по эксплуатации и понять его.

При работе с оборудованием следует использовать средства индивидуальной защиты.

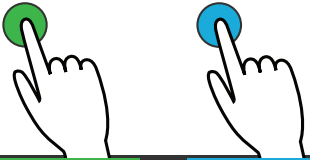

Select

Scroll

Quick Start Guide

LEGEND SERIES

1.

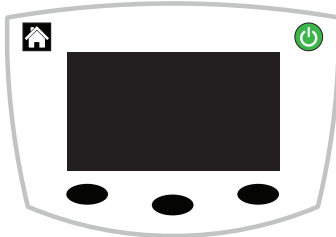

Power On

Press the "Power" Button.

2.



Initialize Software

Press the "Next" Button.

3.

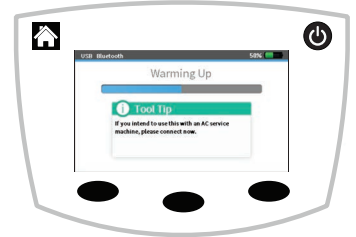

Warm Up

Please Wait for the Progress Bar.

4.



Go To Settings

If You Do Not Wish to Modify Language Settings, Skip to Step 8. Otherwise, Press the "Settings" Button.

5.



Select Language Icon

Use the "Next" Button to Scroll Through the Settings Icons, and the "Check Box" Button to Select.

6.

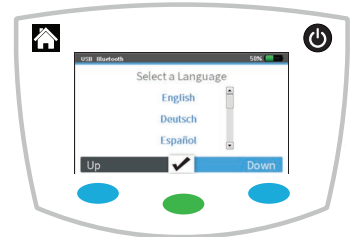

Choose a Language

Use the "Up" and "Down" Buttons to Scroll Through the Language Menu, and the "Check Box" Button to Select.

7.

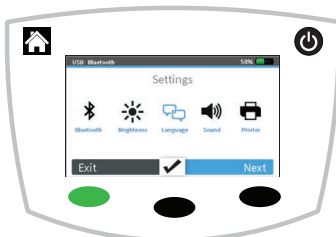

Exit Settings

Use the "Exit" Button to Exit the Settings Menu.

8.

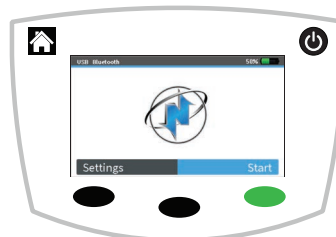

Select Start

Press the "Start" Button to Begin Your Test.

9.



Choose a Refrigerant

Select the Refrigerant You Intend to Test by Pressing Either the "R-134a" Button or the "R-1234yf" Button.

For the Complete User Manual in a Selection of Languages
Please Visit: <https://legend.refrigerantid.com>



10.

Connect Hose

After Connecting the Hose to the Analyzer, Press the "Start" Button to Begin Air Calibration.



11.

Calibrating

Please Wait for the Progress Bar.

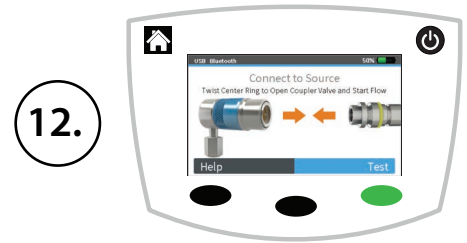

12.

Connect to Source

After Connecting the Coupler to the Refrigerant Source, Press the "Test" Button to Begin the Test.

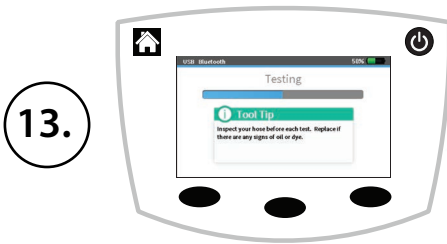

13.

Testing

Please Wait for the Progress Bar.

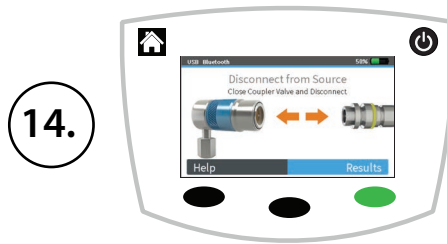

14.

Disconnect from Source

Disconnect the Coupler from the Refrigerant Source. Press the "Results" Button to View the Test Results.

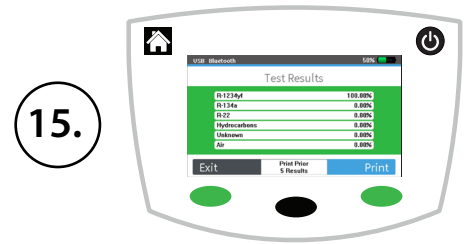

15.

Results

Press "Exit" to Start a New Test. For Analyzers Equipped with a Printer, Press the "Print" Button to Print Results.

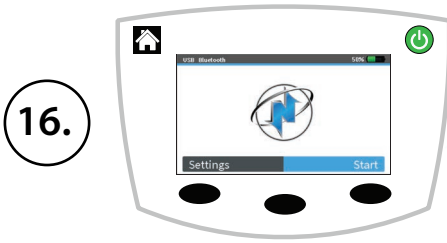

16.

Select Power Down

Power Down the Analyzer by Pressing the "Power" Button.

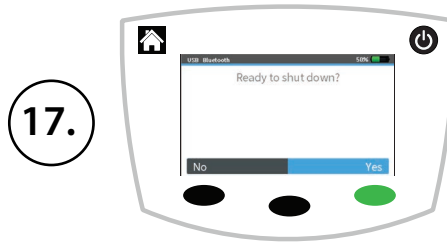

17.

Confirm Power Down

Press the "Yes" Button to Confirm Power Down.



18.

Powering Down

The LCD Screen Will Go Dark When Power Down is Complete.

Legend Series Spare Parts

Part Number	Description
4-03-5004-07-0	R-134a Tank Adapter
5-03-1000-08-1	Printer Paper Roll
5-06-7000-80-0	Operating Manual
6-01-6000-74-0	AC Power Supply
6-02-6001-37-0	R-1234yf Tank Adapter
6-02-6001-42-0	Legend R-134a Replacement Hose
6-02-6001-43-0	Legend R-1234yf Replacement Hose

For Service or Support, Please Contact:

Neutronics Inc.

456 Creamery Way Exton, PA 19341 U.S.A.

Telephone: +1 610.524.8800

Fax: +1 610.524.8807

Email: info@refrigerantid.com

Website: refrigerantid.com