

QCC CONTROLLER

EARTH GROUND SHIELD (inside QCC enclosure)

INDIVIDUAL 4-20 mA SIGNAL WIRE FOR EACH ANALOG CHANNEL

DAISY CHAIN POWER AND GND WIRES RUNNING TO FOURTH TRANSMITTER.
ONE SIGNAL WIRE MUST BE PULLED FOR THE FOURTH TRANSMITTER.

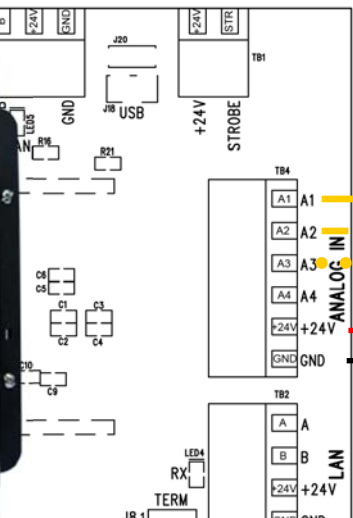

CETCI
QCC MAIN PCA Rev B

LINE VOLTAGE

THREE RELAY CONTROL WIRING TERMINALS.
CONNECT TO COM & NC. DO NOT USE SOLID CORE WIRE.
RELAYS OPERATE IN "FAIL SAFE" CONFIGURATON.

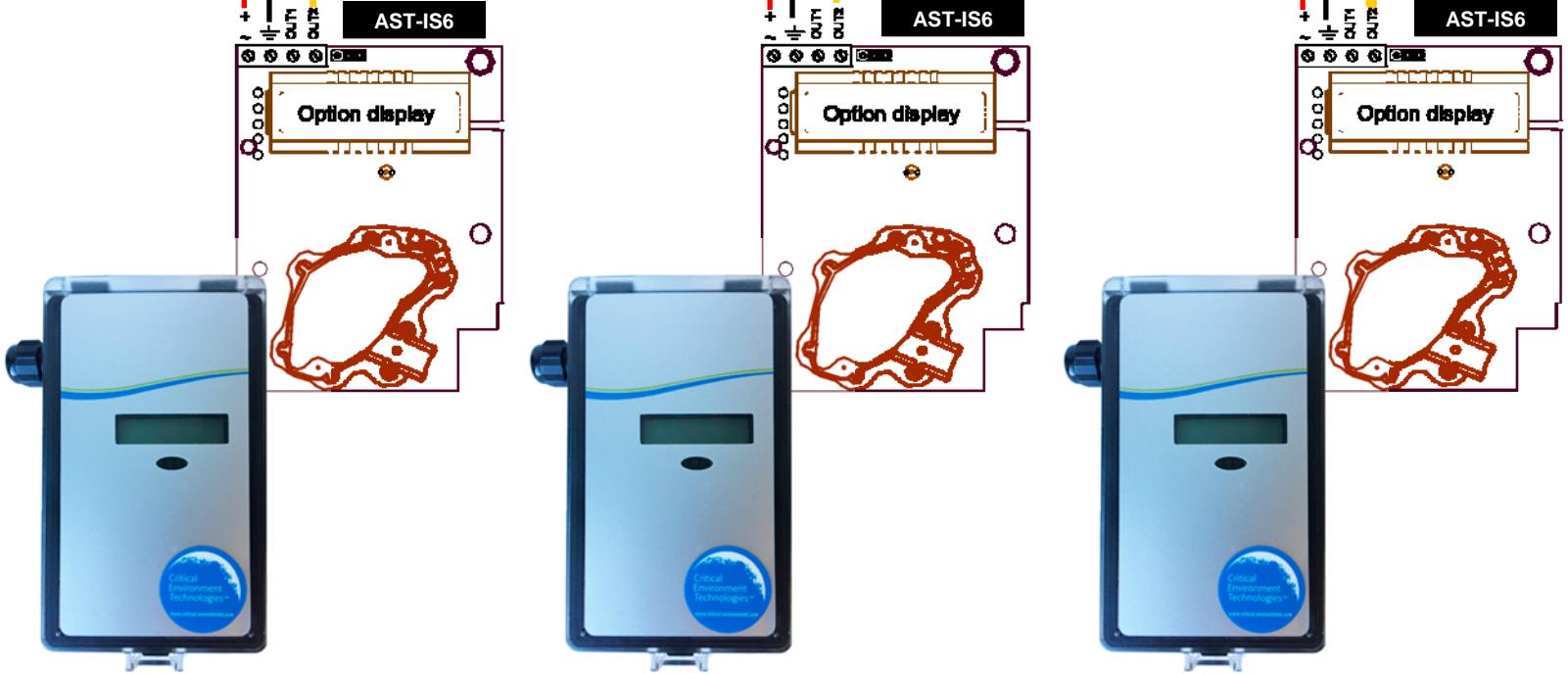
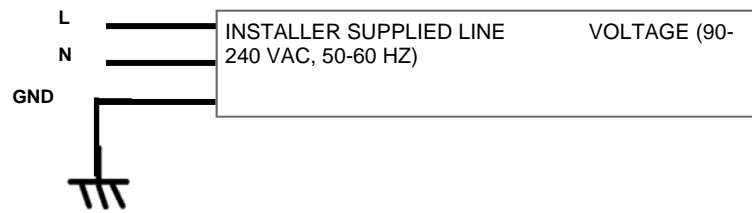
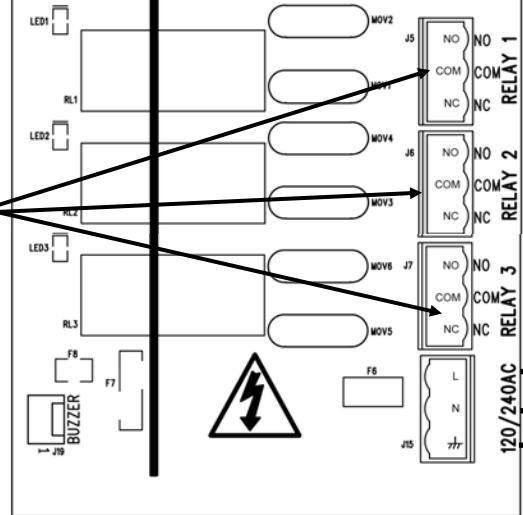

CRITICAL ENVIRONMENT TECHNOLOGIES CANADA INC.
www.critical-environment.com

QCC TO AST-IS6 INFRARED CO2 ANALOG TRANSMITTERS
WIRING CONNECTION DRAWING

REV-A October 18, 2017